

THIS DOCUMENT MUST NOT BE COPIED OR DISCLOSED TO A THIRD PARTY WITHOUT THE WRITTEN CONSENT OF PANORAMA ANTENNAS LTD.

DO NOT SCALE

PROJECTION



AVHB-VAR

DRG. No.

THIS IS A PROPRIETARY ITEM OF PANORAMA ANTENNAS LTD. AND COULD BE SUBJECT TO CHANGE WITHOUT PRIOR NOTICE. THIS ITEM IS RoHS COMPLIANT.

△ — DENOTES LATEST ISSUE CHANGES

END TIP MADE FROM BLACK ENGINEERING PLASTIC — GLUED ON

STAINLESS STEEL ROD TYPE 17-7PH — FINISHED IN BLACK.

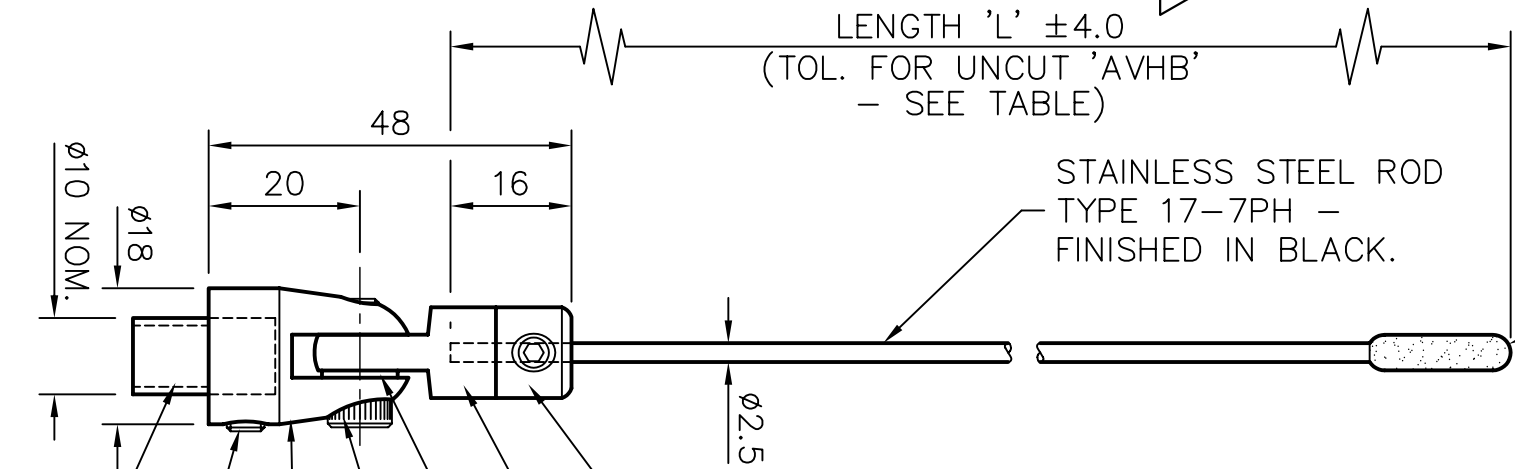

PART No.	FREQUENCY RANGE IN MHZ	LENGTH 'L' IN mm
AVHB	UNCUT	1220 MIN.
AVHB-E3	67-74	1061
AVHB-E4	74-81	962
AVHB-E5	81-88	861
AVHB-H1	104-108	697
AVHB-H3	132-143	498
AVHB-H4	141-151	467
AVHB-H5	149-159	444
AVHB-H6	156-162	428
AVHB-H7	162-174	405
AVHB-JRC	139-157	460
AVHB-K5	174-192	371
AVHB-K6	192-208	340
AVHB-K7	208-225	311
AVHB-L	220-250	287

- UNSCREWABLE BRASS WHIP HOLDER FINISHED IN BLACK.
- BRASS HINGE FINISHED IN BLACK.
- FRICITION WASHER.
- SOCKET HEAD CAP SCREW STAINLESS STEEL FINISHED IN BLACK.
- BRASS HINGE ADAPTOR FINISHED IN BLACK.
- 2 SOCKET SET SCREWS STAINLESS STEEL FINISHED IN BLACK.
- NYLON TUBE TO PREVENT LOSS OF SCREW IN TRANSIT

C/NOTE	ISSUE	DATE	SGN.	TOLERANCES UNLESS OTHERWISE STATED	MATERIAL	TITLE	DRG. No.	FILENAME	DATE	SCALE
00850	3	10.3.94	K.D.	±0.2		ANTENNA VHF HINGED 1/4W — BLACK	AVHB-VAR	AVHB-VAR	© 1993	1:1
00899	4	15.4.94	K.D.	±0.1						
00565	5	15.4.98	K.D.	±0.1						
01716	6	25.8.00	K.D.	±0.1						
01731	7	19.12.00	K.D.	±0.1						
01019	8	01.02.07	K.D.	±0.1						

PANORAMA ANTENNAS LTD. LONDON

© 1993

A4